

BRAVA 1

Colonna 2 ante 1 cesto
inserimento lavatrice

60x34x210 h.

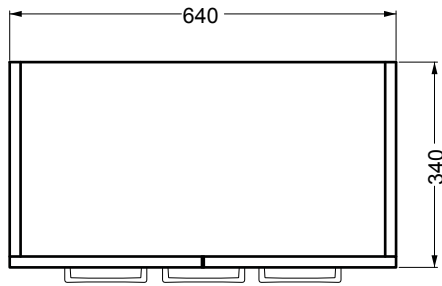

PIANTA

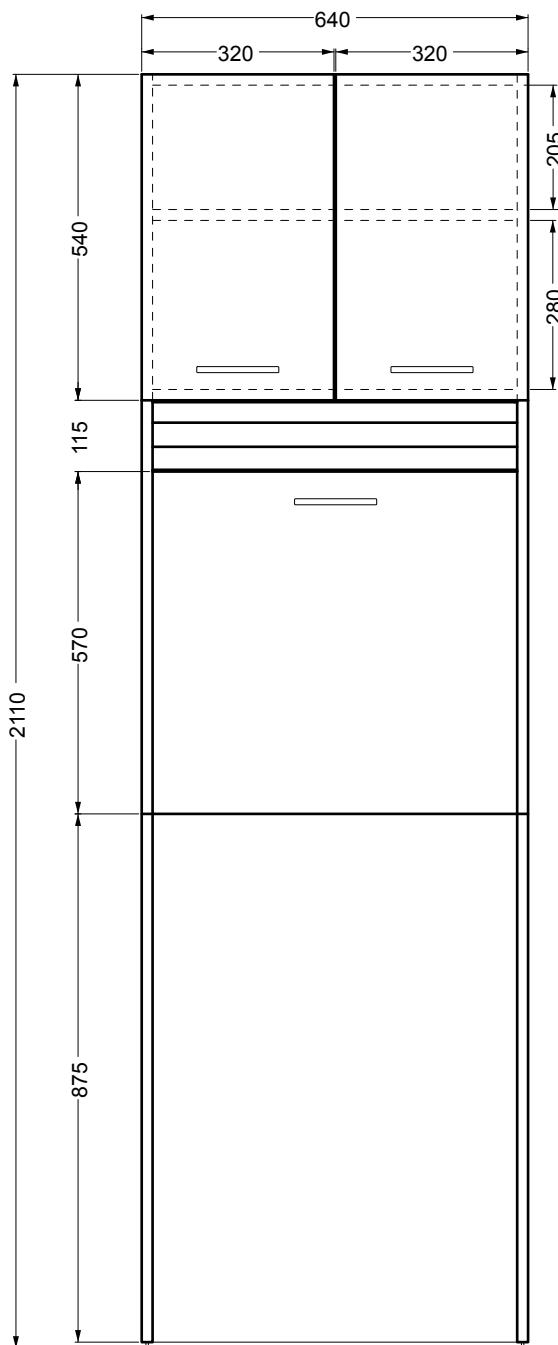

VISTA FRONTALE

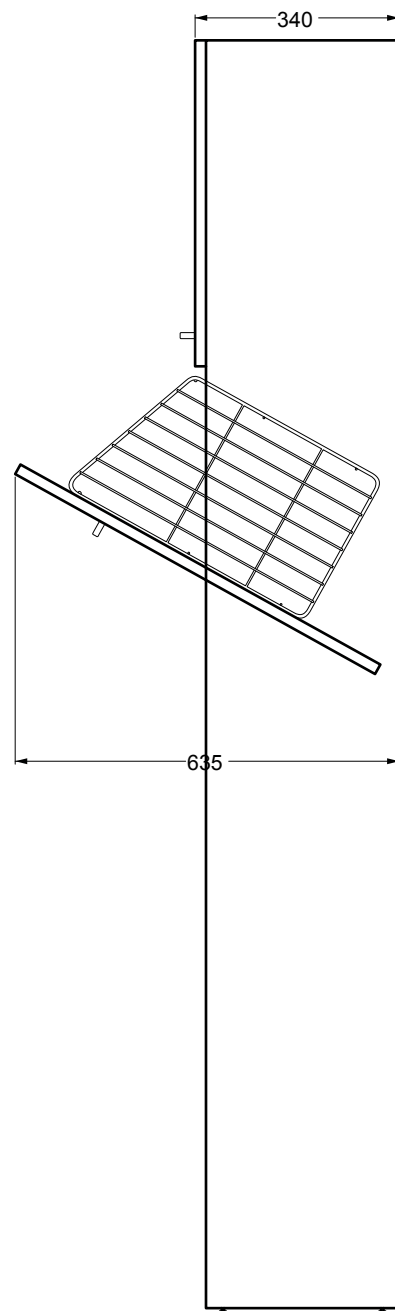

VISTA LATERALE

BRAVA 2

Colonna 2 ante e 2 cesti
60x34x210 h.

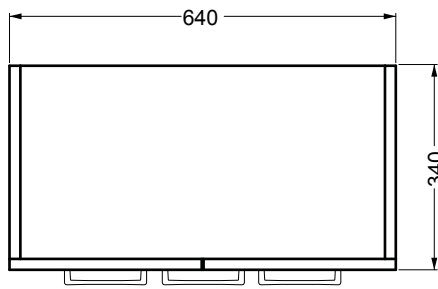

PIANTA

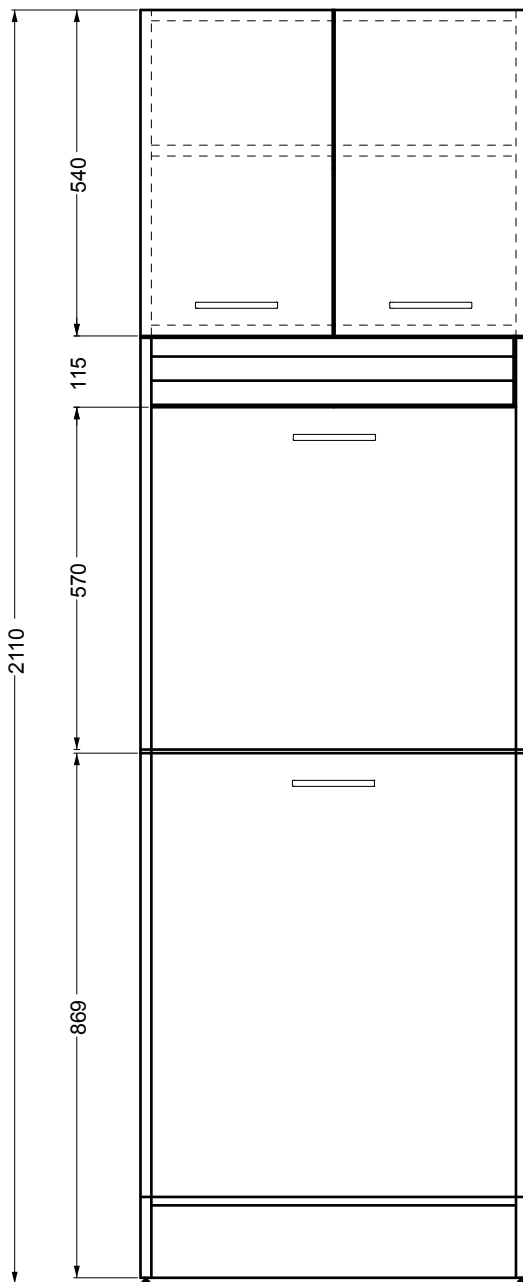

VISTA FRONTALE

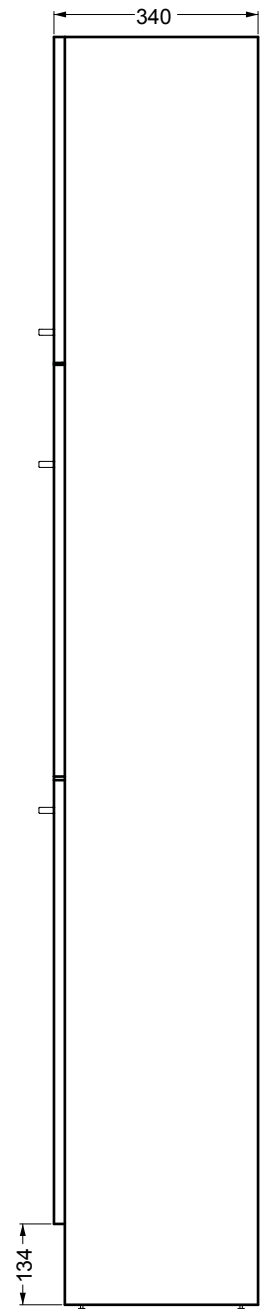

VISTA LATERALE

BRAVA 3

Colonna 1 cesto 2 ante superiori
2 ante inferiori
60x34x210 h.

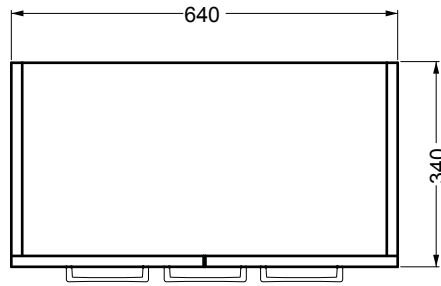

PIANTA

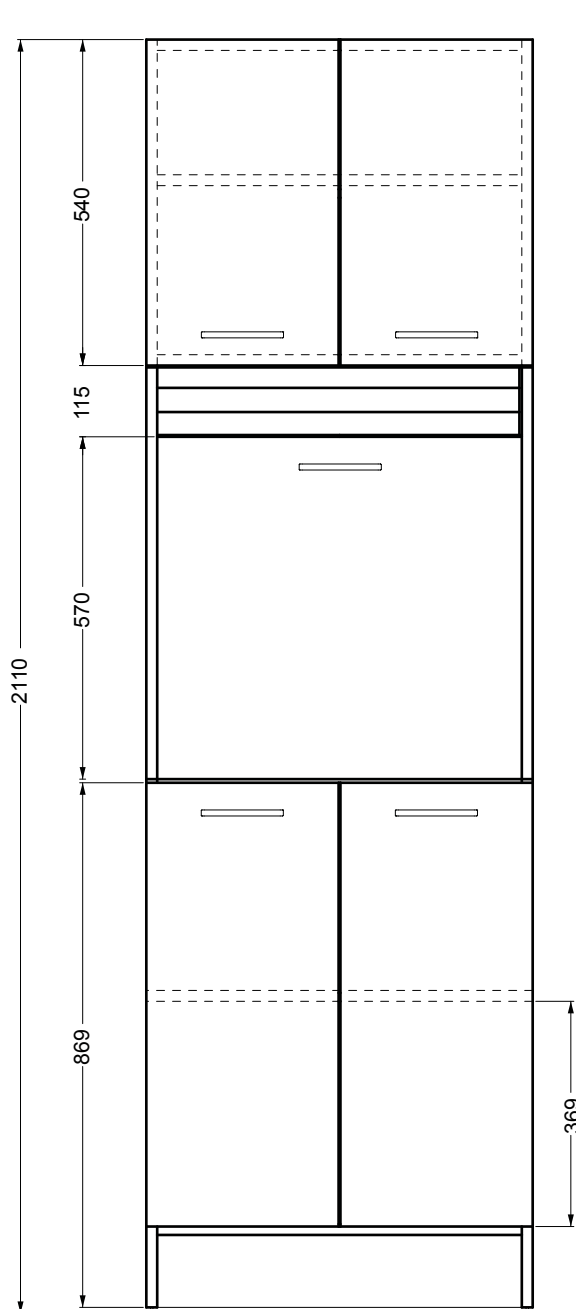

VISTA FRONTALE

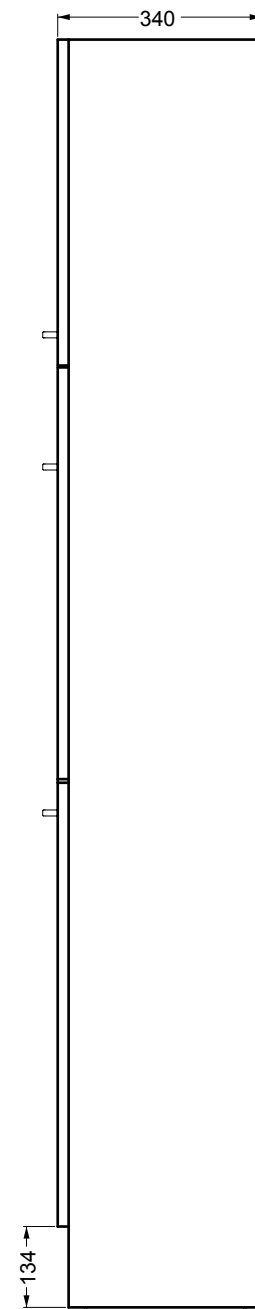

VISTA LATERALE

BRAVA 4

60x34x210 h.

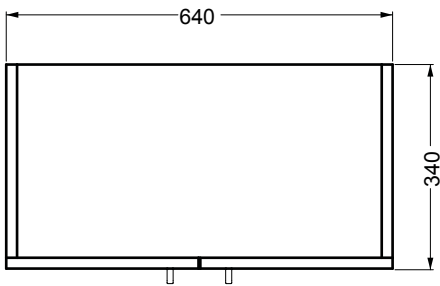

PIANTA

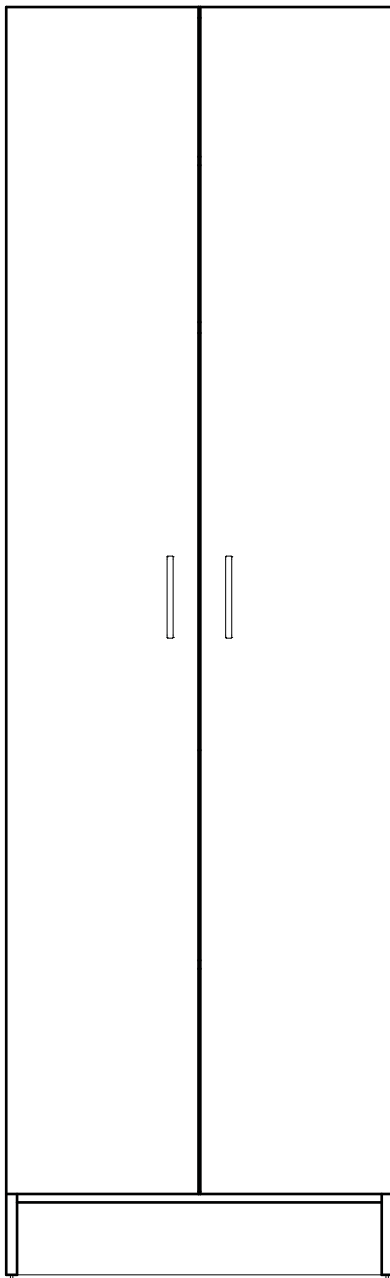

VISTA FRONTALE

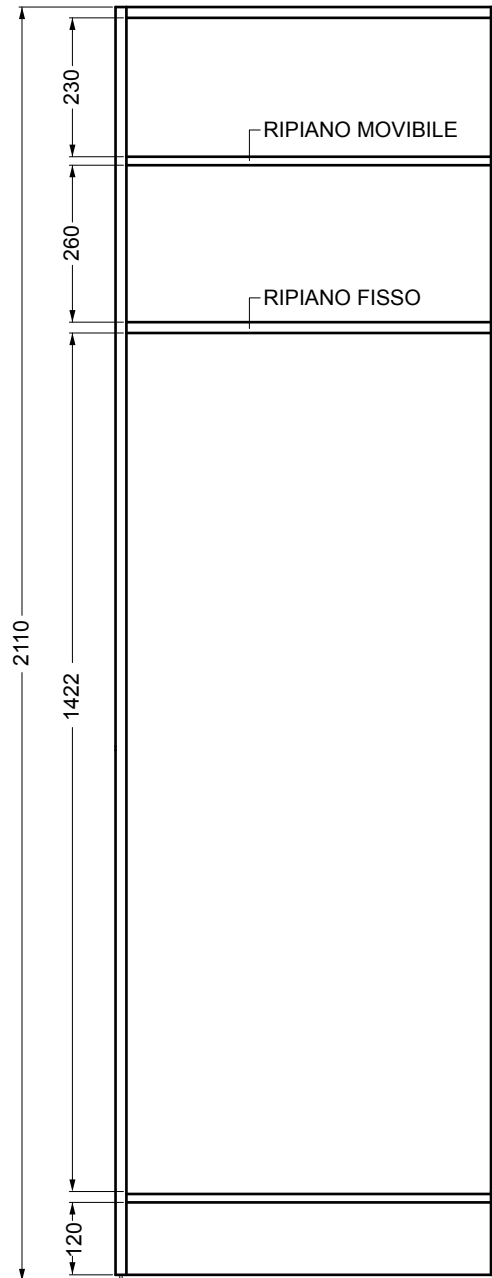

VISTA FRONTALE SENZA ANTE

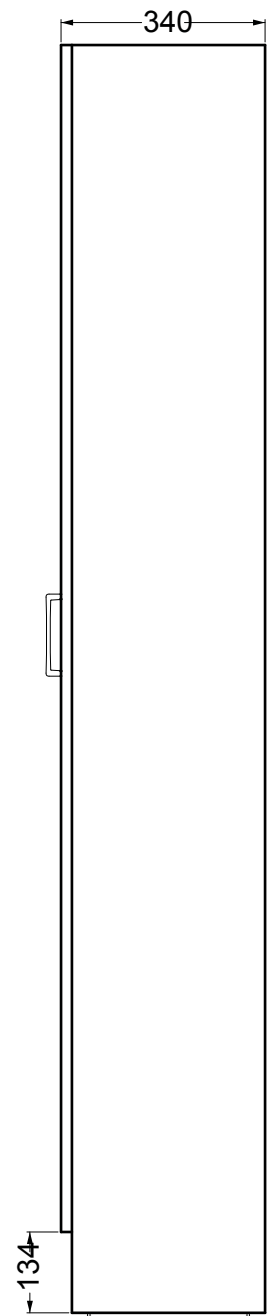

VISTA LATERALE

BRAVA 5

Colonna sospesa con
anta superiore, antina basculante e anta
inferiore apertura vasistas con
cesto portabiancheria
DX-SX
44x34x120 h.

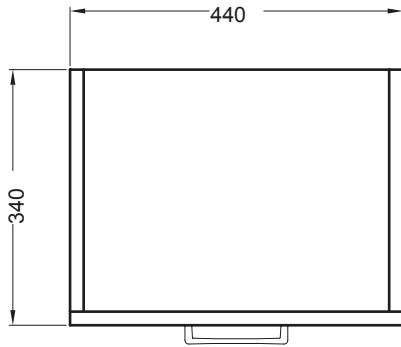

PIANTA

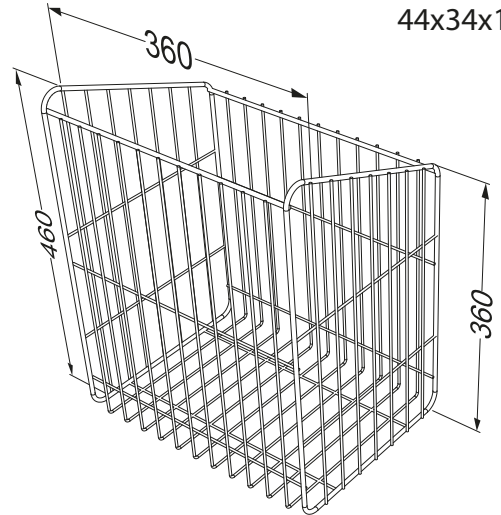

CESTO PORTABIANCHERIA

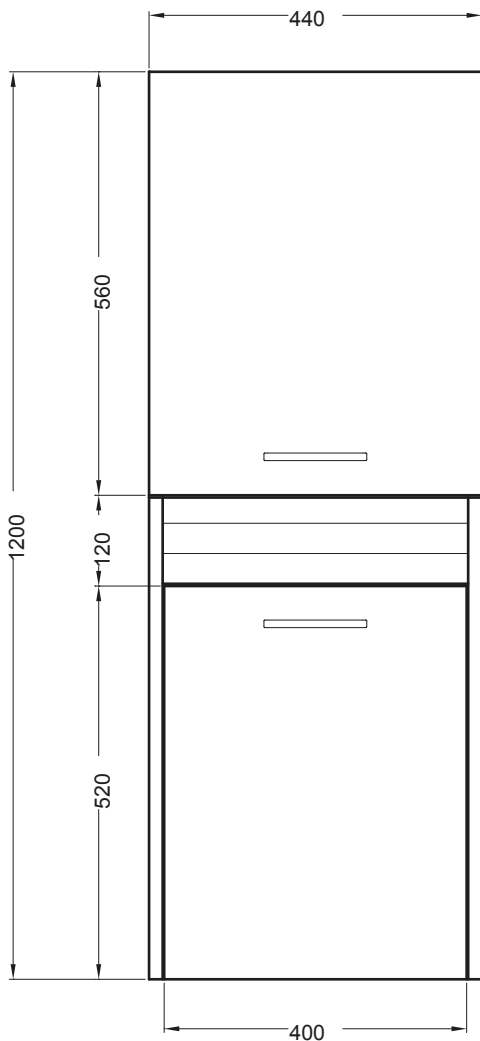

VISTA FRONTALE

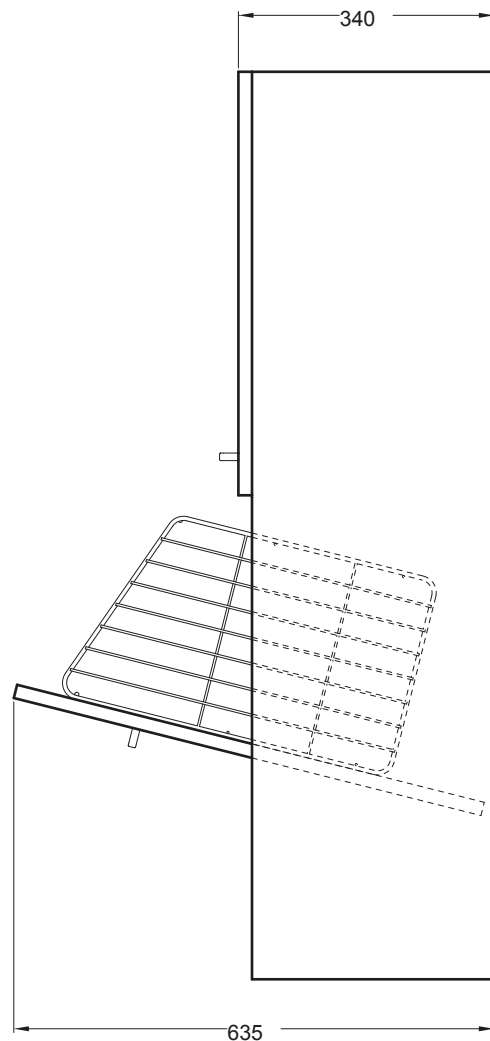

VISTA LATERALE CON CESTO APERTO

BRAVA 6

Colonna sospesa 2 ante e 2 ripiani interni
 DX-SX
 60x34x210 h.

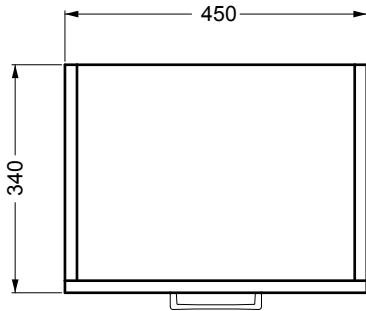

PIANTA

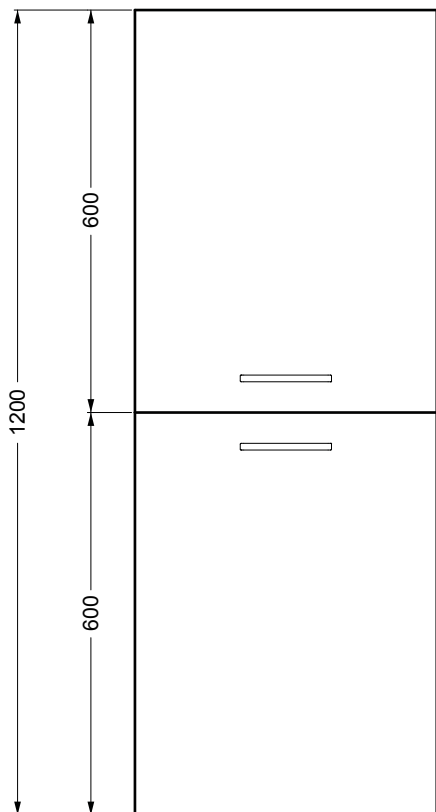

VISTA FRONTALE

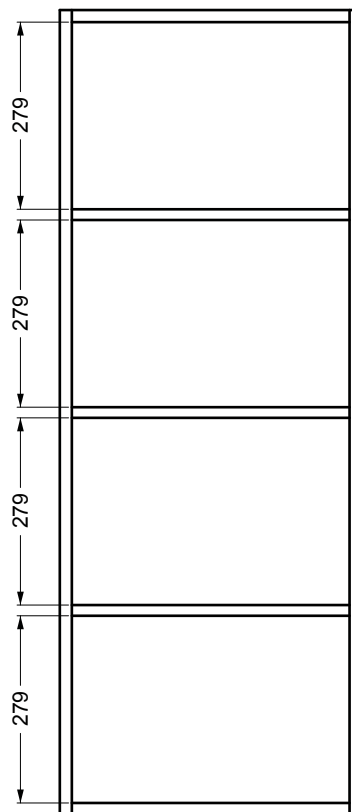

VISTA FRONTALE SENZA ANTE

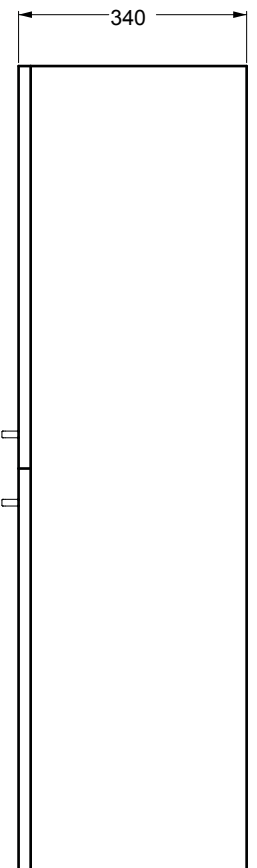

VISTA LATERALE

BRAVA 7

Colonna sospesa 1 anta con ripiano interno
 3 cassetti
 DX-SX
 45x34x120 h.

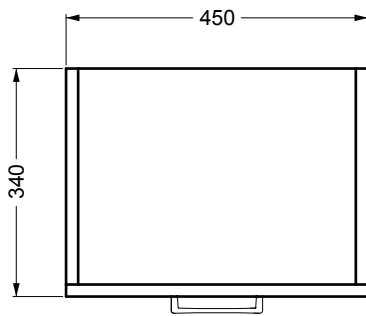

PIANTA

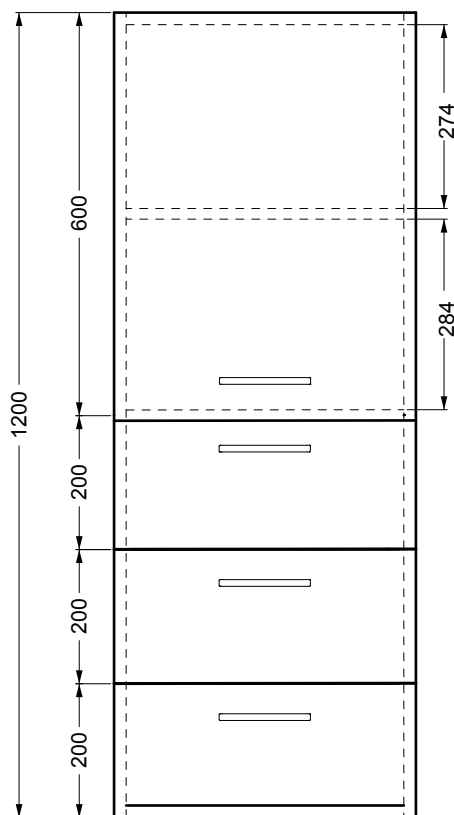

VISTA FRONTALE

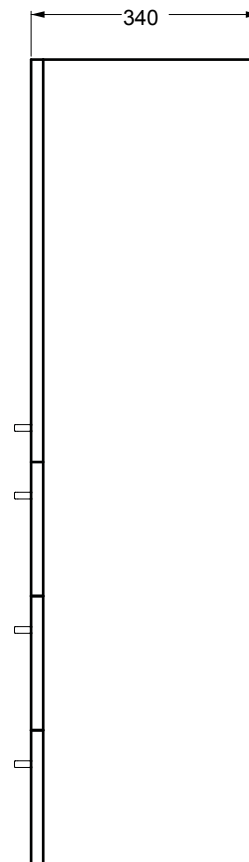

VISTA LATERALE

BRAVA 8

Colonna sospesa 2 ante e 2 ripiani interni
DX-SX

60x34x120 h.

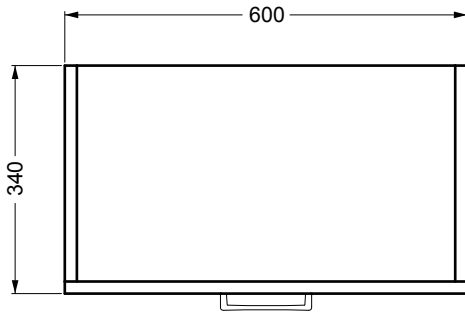

PIANTA

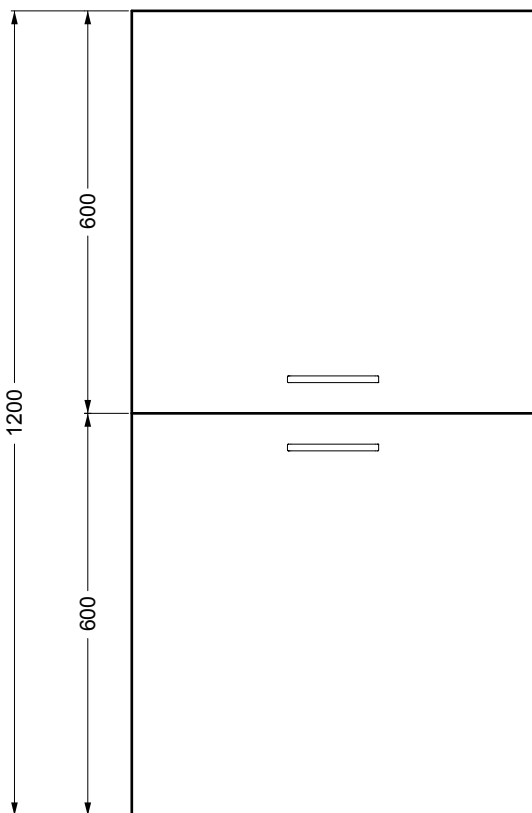

VISTA FRONTALE

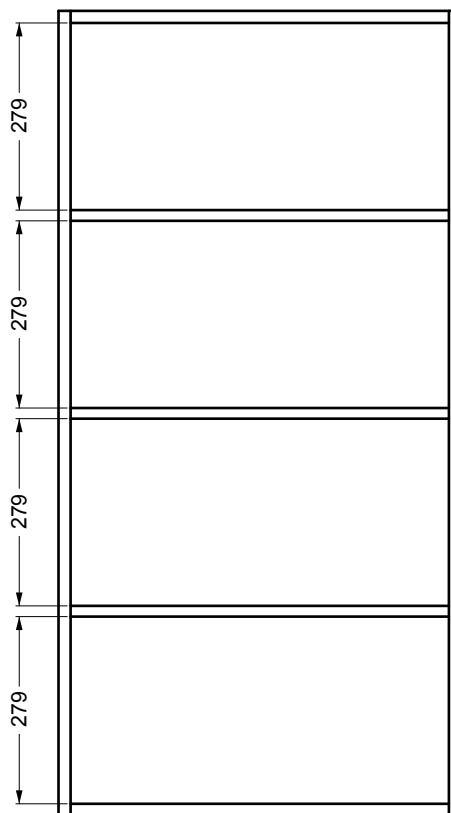

VISTA FRONTALE SENZA ANTE

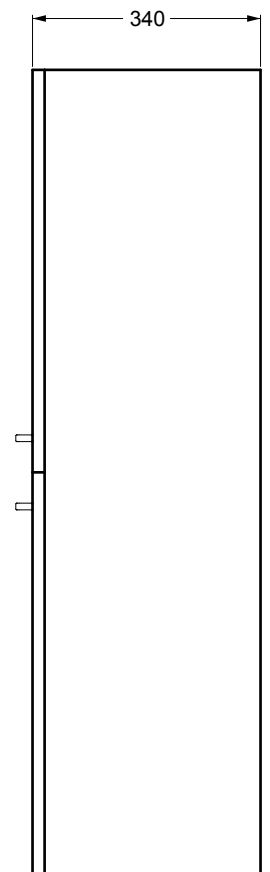

VISTA LATERALE

BRAVA 9

Colonna sospesa anta superiore
con ripiano interno e anta inferiore apertura
vasistas con cesto portabiancheria
60x34x120 h.

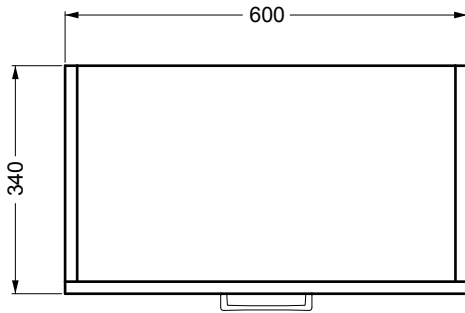

PIANTA

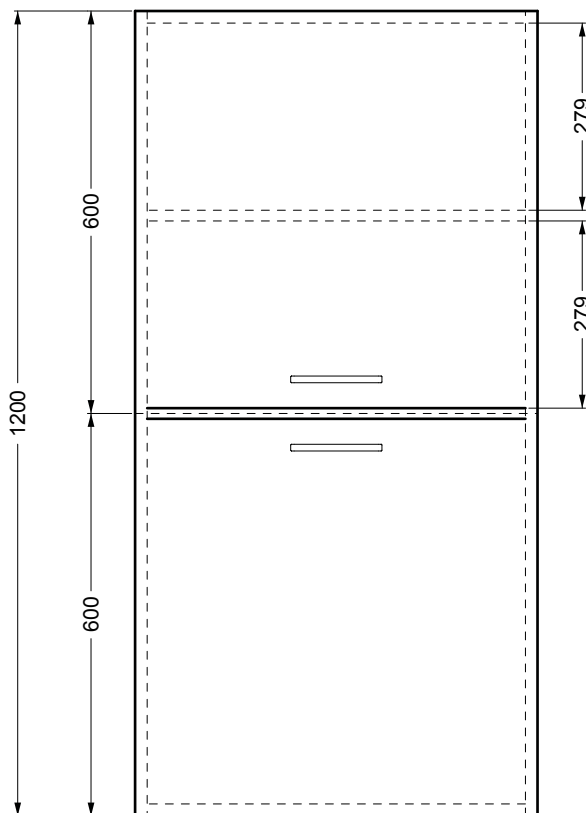

VISTA FRONTALE

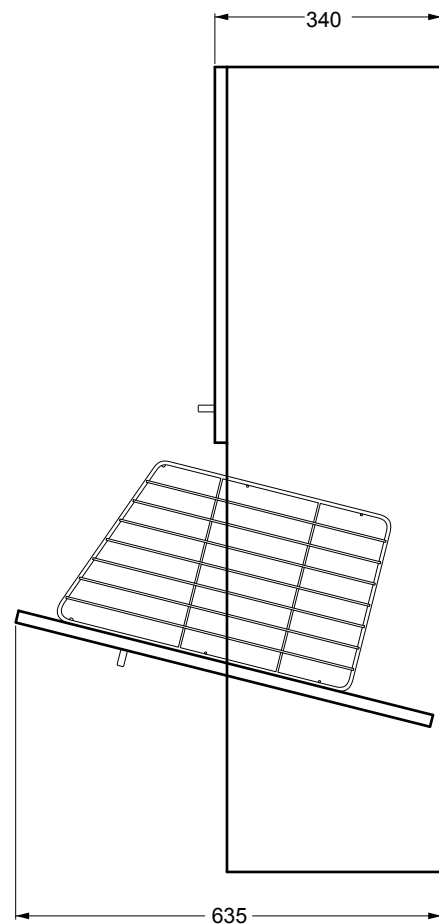

VISTA LATERALE CON CESTO APERTO

COLONNA BRAVA 10 64X34XH210

COLAVENE

- 27041

Mobile in truciolare nobilitato da 18 mm. Idrofugo a norme EN,
frontale in laminato lucido.



Disegni Tecnici

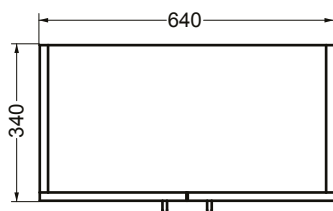

PIANTA

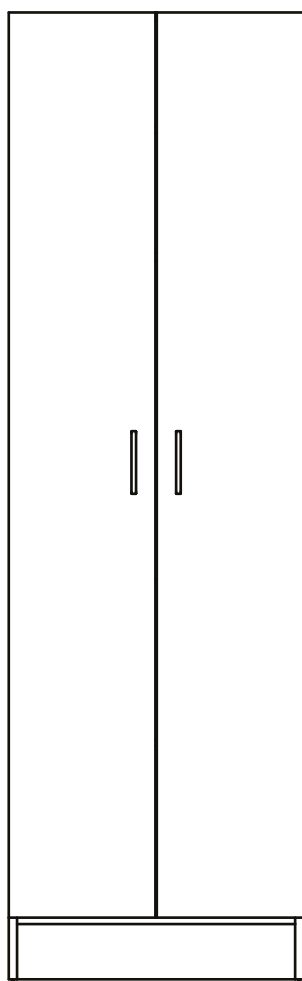

VISTA FRONTALE

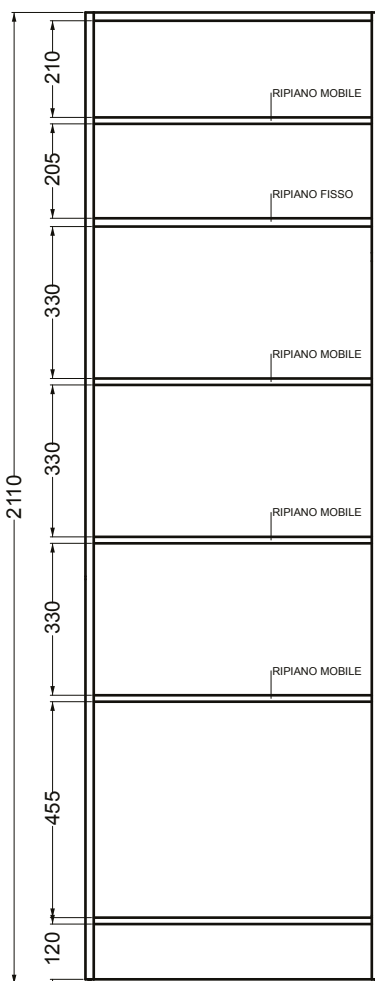

VISTA FRONTALE SENZA ANTE

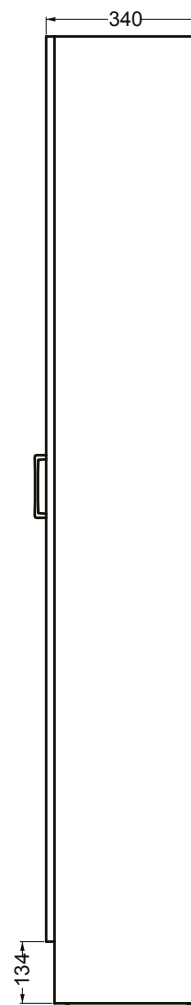

VISTA LATERALE