

**Air bubble function:** press (  ) for 3 seconds, then air bubble can work (Special notes: This means a feature requires an optional accessory.)

**Underwater lamp function:** Press (  ) key can start or stop the underwater light.

**Faucet lamp function:** Faucet lamp will light up when the control panel lights up.

**Faucet elevating function:** press (  ) key to let the faucet go and down.

**Auto drainage function:** When the control panel is closed, the drainage valve starts, then it automatically shut down after 15 minutes.

**Auto ozone function:** When the control panel is closed, ozone generator starts, then it automatically shut down after 15 minutes.

### 6.Items For Attention

1. The system must be erected by qualified technical person and the leakage switch shall be mounted in place of easy control .
2. It must be connected firmly during erection .In the case of loss due to improper earthing ,the manufacturer will not assume any responsibility .
3. The motor must be erected flatly and stably and the shell shall be firmly earthed .
4. The whole set is usually under standby state. If it is not used for long time, please pull off the master power switch.
5. During erection, it is required to consider load capacity of power supply circuit, otherwise it may influence the normal working of the system or cause accident.
6. During erection, all the electric appliances and electric parts shall be provided with moisture resistant measures.
7. Each LED control panel light twinkle automatically when this function is operating.

# User's Guide

## IMPORTANT:

Read this manual before proceeding with installation of the bathtub and keep it with the other accompanying documents.  
This manual is valid for the installation of tubs both with and without whirlpool.

**MODEL: VITTORIA**

**SIZE:2000X900X620mm**



Install the diagram

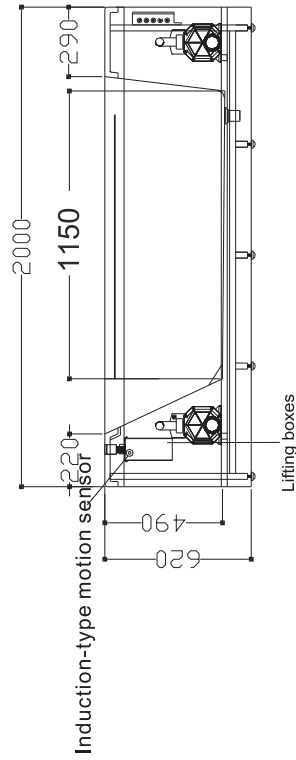

Plane chart

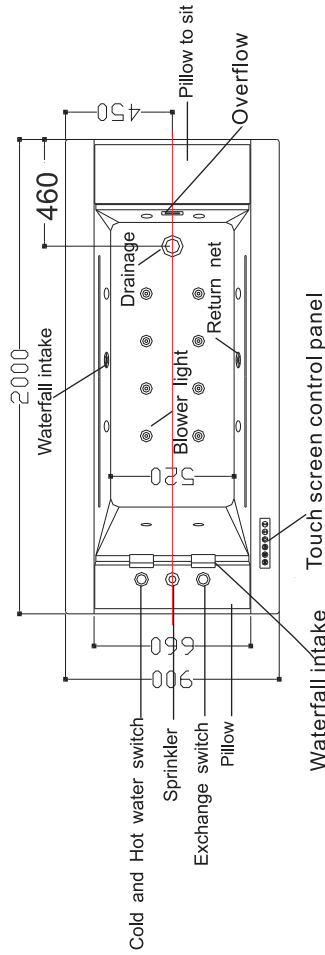

Tap takes over sketch

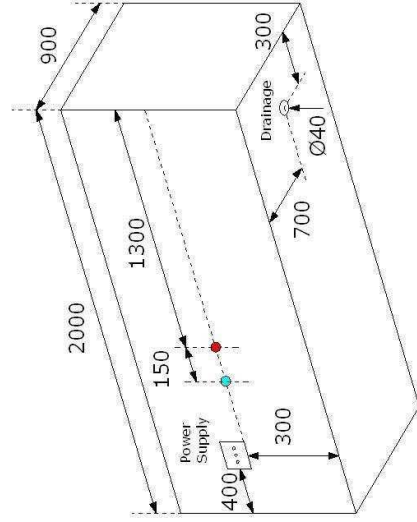
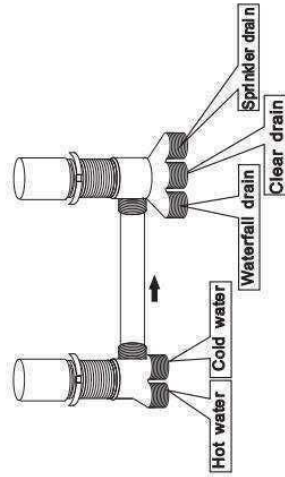

IV. CONTROL PANEL DESCRIPTION

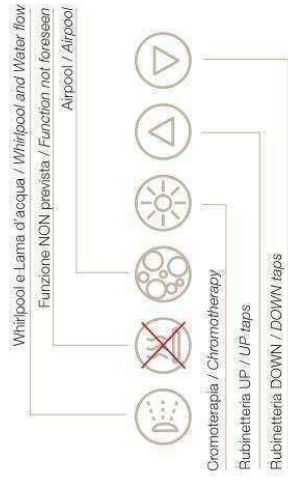

5. OPERATING INSTRUCTION

**Induction-type motion sensor:** When the control panel is off, it will light up again by detection of the human body infrared sensor as long as the user approaches.

**Pump surfing function:** There is a function of water shortage protection. The highness of the water in the bathtub must meet the standards in order

to start the pump. Press key to start the pump and shut down. The pump will automatically shut down after working 60 minutes every time.

**Waterfall function:** Press ( ) button, another water pump starts, then the waterfall starts, and will automatically shut down after working 60 minutes every time or click it to stop.

**Waterfall volume adjustment:** Press to adjust the waterfall

volume. Press for several seconds can adjust the waterfall volume at where the user likes. When the right side waterfall is in large volume, the left side is in small volume, and vice versa. Let go can stop changing at where the user wants to stop.

**Thermostat function:** the function by the control of water pump function, only in open water pump function, constant temperature function will normal start, surfing function is closed it with with closed, according to ( ) key can activate or deactivate the thermostat.

**Heater function:** Heater function can only work when the whirlpool function is working. When the whirlpool function stop, heater function will stop.

Press ( ) key to start or stop the heater function.

**(Special notes: This means a feature requires an optional accessory.)**

### 1.Functions(WS-04)

NO.	Functions	Available
1	Touch sensitive control panel	✓
2	whirlpool massage function	X
3	Waterfall function	✓
4	color light	✓
5	Air bubble	*
6	Heater	*
7	Auto ozone	✓
8	Auto drainage	✓

Remark : the function with "✓" means the standard function, and the function with "\*" means the optional function.

### 2.SPECIFICATIONS

- Power supply AC220V±10% 50-60Hz 7、Jacking motor AC12V 40W
- Pump load ① AC220V 750W 8、 Waterfall Magnetic valve DC12V 30W
- Pump load ② AC220V 750W 9、 Drainage Magnetic valve DC12V 10W
- Under water lamp load:AC12V 10W 10、 Dielectric strength 1500V/5MA 1min
- Leak current <0.25mA

6. Faucet Lamp load AC12V 10W

### III.CIRCUIT DIAGRAM:

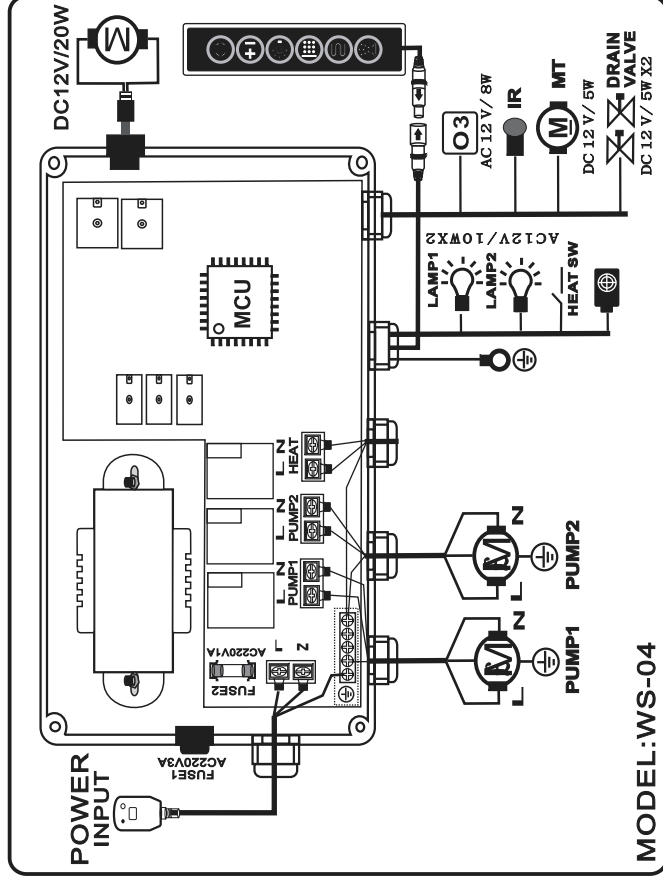

MODEL:WS-04

### 1、 Electricity parameter

Rated voltage	Rated power	Rated electric current	Reference circuit voltage
220VAC	1850W	<4A	12V

### 2、 Electric installation

- power supply's establishment should be complied with nation security standard, voltage and frequency also should be accord with product's nameplate. Especially install creep-age protect switch and also check whether can connect with ground.
- The wire collected to the massage bathtub should be fitting permanent., and the wire should be a three-core wire, the sectional acreage of each core cannot less than 12A. when wire pass the wall, it should be use bushing for protection until the AC outlet.
- Ground wire of bathtub should be test whether works with house appliance ground wire.
- The wire end of electricity control box should connect to the control panel, water bottom light, loudspeaker, electrical engineering and the detector protection respectively.

### 3、 Water supply device

- This device's hydraulic pressure is 0.2-0.4Mpa.
- The water supply characteristics on the wall: The cold or hot water supplies inside the bathroom also establish in the shelter of the massage tub, use the hose to connect with the cold or hot joint of the tub, the pipe towards is decide by the customer, the machine do not go with the hose.

### 4、 Installation introduction

- Before install, must consider the place of install massage bathtub whether can support this device's pressure.
- Place the massage bathtub on the install position, adjust level to make the drain system smooth.
- Adjust the leg's screw to make sure all of the screw touch ground completely.
- Install the drain hose, and make some measure to against on the connector.
- Fix cold and hot water-pipe well, then install the showerhead. And then put drain into downcomer, finally connect with power and make sure whether device connected with ground can work.

### 5、 Using Method

- Turn on faucet, adjust water's temperature, add water to the massage bathtub. when the highest water level exceed the highest nozzle about 20-30mm and reach the detector, press the switch button to let the electric machine.
- Revolve the adjust switch, and choose the proper surf pressure.
- After finishing if should turn off pump at first, then open drain button, when water is all out, please make a clean of bathtub to keep in good.

### 6、 Clean and keep in good condition

- usually use soft cloths and general liquid cleanser can wash away dirt, but forbid to use the cleanser with acetone or the ammon ia composition. when disinfect, forbid to use the disinfectior contained the formaldehyde.
- the dirty spot of surface can use the toothpaste to wipe with the soft cloth.
- to the low-grade chafe of the surface or burned by cigarette, can soak in water to whet with 2000# levigation sand paper, then polishing.
- if the electroplate piece contain stain, use the soft cloth to wipe lightly, avoid to wiping with coarse cloth.
- often clean up the backwater net cover, prevent it from stop.

- 6.6 Check whether have break on pipe and waterway aperiodically.
- 6.7 Please check whether there is fall off or breakage on wire, switch, connector, plugs so that repair in time.
- 6.8 In order to keep to use in a long term, please remember, don't use more than 3 hours continually.

### 7、Fault eliminate

Fault	Cause	Way
Machine or equipment doesn't work	Voltage unstable	Check circuitry
	Power connector didn't connect well or open circuit	Insert again or change power line
	The windpipe connect air switch fall off or break	Connect again or change
Big nose of machine	The air switch failure	Change
	Power's parameter is not same as nameplate	Connect with supplier
	Fixed screw did'n fix or fall off	Fix tightly again
water pipe leak out	Support's leg screw did not touch ground	Adjust
	Aging	Change
	The joint did not fix well	Fix again
	Water pipe or accessory leak	Change

Remark: except this fault, please according to situation to resolve, or find experienced people to repair.

### 8、special remind

- 8.1 please find qualified people to install bathtub according to introduction.
- 8.2 when you are using it, first of all you have to inject the cold water and then inject the hot water. Don't inject the hot water first.
- 8.3 bathtub's machine must connect on ground, support must use 1.5mm<sup>2</sup> yellow/green double wire connect with ground and check whether effective.
- 8.4 please do not turn on machine without water, before draining should turn off machine.
- 8.5 children should be looked after in bathtub.
- 8.6 bathtub's temperature can't higher than people average temperature, and the best is 32-37centigrade.
- 8.7 after shower, please cut off power.
- 8.8 if have these situation, please do not enter into massage bathtub.
- 8.8.1 younger than 4 years old's child;
- 8.8.2 blood circulation unstabled people;
- 8.8.3 sot;
- 8.8.4 suffer from flu;
- 8.8.5 heart disease;
- 8.8.6 already have sauna;
- 8.8.7 after meal in half a hour;

Remark: our company has the right to modify the above mention without further notice.

## Bathtub User's Guide

### WARNINGS

1. Please follow the instruction contained in the attached installation manual to ensure that the product is installed properly. the manufacturer will not be held liable for damages or injuries caused by improper installation.
2. Follow the instructions contained in this manual when using the product.
3. Before using the bathtub, check the local voltage that if reach to the rated voltage(pre-installation card).

## CONTENTS

- I. Safety Precautions
- II. Brief Introduction
- III. CIRCUIT DIAGRAM
- IV. CONTROL PANEL DESCRIPTION
- V. Items For Attention

# SISTEMI IDROMASSAGGIO

## HYDROMASSAGE SYSTEMS

### VASCHE CON CASCATA / BATHTUBS WITH WATERFALL

#### SISTEMA TOUCH RETROILLUMINATO BACKLIT TOUCH SYSTEM

Mod. ANGEL  
Mod. VITTORIA

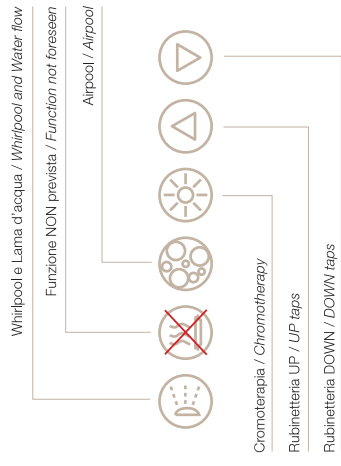

SPENTO / OFF



ACCESO / ON

#### GETTI JETS



Getto Whirpool  
Whirpool jet

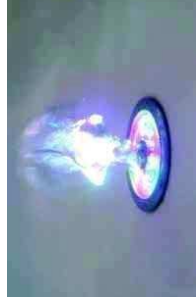

Getto Airpool con Cromoterapia  
Airpool jet with Chromotherapy



Lama d'acqua e bocca di erogazione  
Water flow and bath spout

#### RUBINETTERIA A SCOMPARSA CONCEALED TAPS

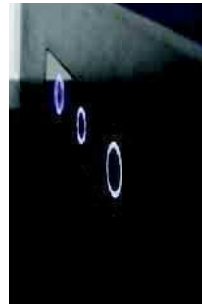

Rubinetteria incassata  
Recessed taps



Miscelatore + erogatore, doccia e deviatore  
Mixer + dispenser, hand shower and diverter



Doccino estraibile  
Extractable hand shower